

Dome rooflight safety concept burglary prevention device and fall-through protection

VELUX®
Commercial

An ingenious package solution against burglary and for greater safety on the roof

Safety level 1

SUPER-TOP/HAILSTOP/TOP-90 sound reduction
Dome rooflights/pyramids with outer shell made of high-impact resistant polycarbonate and screw connection securing

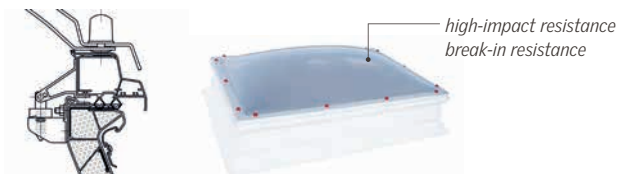

Safety level 2

Steel grids installed in the clear opening (see cover picture) or type DSD fall-through protection system installed directly on the trapezoidal sheet

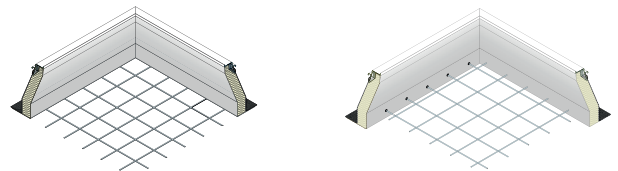

Safety level 3

Steel tubes with large dimensioned cross bar installed in the clear opening

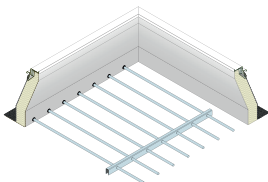

Safety level 4

Roller grate security according VdS-guideline 2333 with reinforced cross bar as burglary resistant securing in compliance with resistance class 3 according to DIN V ENV 1625.

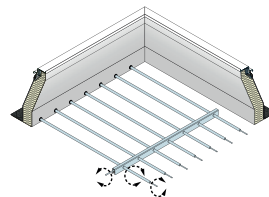

Safety level 5

Level 1 to 4 with additional securing by REED flap contact against unnoticed opening and EM concussion detector for detection of impact load of any character. Starting from safety level 2, TOP-90 dome rooflights can be used as an alternative.

1.1.1
TOP-90

1.1.2
TOP-90 PLUS

1.1.3
TOP-90
sound reduction

1.2.1
Dome rooflight upstands and
roof connection systems

1.4.5
LK-DDS

1.4.6
LK-DDN

Applicable for the upstand types (cm)		Steel grid	Steel installation-tubes/ roller grate security			DSD	LK-DDN		LK-DDS ROUND
		Factory setting	Factory setting	Sub-structure	Retrofit kit	Sub-structure	Factory setting	Retrofit kit	Retrofit kit
Metal-AK									
ISO-THERM AK upstand	30	-	-	•	•	•	-	•	-
ISO-THERM AK upstand	40/50/60	•	•	•	•	•	-	•	-
ISO-THERM AK upstand steep	30/40/50/60	•	•	•	•	•	-	•	-
ISO-THERM AK upstand AS	40/50	•	•	•	•	•	-	•	-
Metal AK upstand type TE	30	-	-	•	•	•	-	•	-
Metal AK upstand type TE	40/50	•	•	•	•	•	-	•	-
Metal RAK upstand	30	-	-	•	•	•	-	•	-
Metal RAK upstand	40/50	•	•	•	•	•	-	•	-
Aluminium TRP AK upstand	15/30	-	-	-	-	-	•	•	-
Aluminium TRP AK upstand	30	-	-	-	-	-	•	•	-
Aluminium thermal TRP AK upstand	15/30	-	-	-	-	-	•	•	-
Aluminium thermal TRP RAK upstand	30	-	-	-	-	-	•	•	-
Steel aluminium composite upstand	30	-	-	•	•	•	-	•	-
Steel aluminium composite upstand with base flange	30	-	-	•	•	-	-	-	-
Steel aluminium composite RAK upstand with base flange	30	-	-	•	•	-	-	-	-
Steel aluminium composite AK upstand with TRP-side bend	30	-	-	•	•	-	-	•	-
Steel aluminium composite AK upstand with hot flange preparation	40	•	•	•	•	•	-	•	-
Steel aluminium composite RAK upstand	30	-	-	•	•	•	-	•	-
Steel aluminium composite RAK upstand with TRP-side bend	30	-	-	•	•	-	-	•	-
Steel aluminium composite RAK upstand with hot flange preparation	40	•	•	•	•	•	-	•	-
Steel aluminium composite TRP-AK upstand	30	-	-	•	•	-	-	•	-
Steel aluminium composite TRP-RAK upstand	30	-	-	•	•	-	-	•	-
PVC AK upstand									
PVC AK upstand	15/30/45	-	-	•	-	•	-	•	-
GRP-AK									
GRP AK upstand	15/30/50	-	-	•	-	•	-	•	-
GRP RAK upstand	30/45	-	-	•	-	•	-	•	-
GRP upstand AK corrugated profile	20/30	-	-	•	-	-	-	•	-
GRP upstand RAK corrugated profile	30	-	-	•	-	-	-	•	-
GRP TRP RAK upstand	30	-	-	•	-	-	-	•	-
GRP AK upstand with TRP-side bend	15/30/50	-	-	•	-	-	-	•	-
GRP RAK upstand with TRP-side bend	30	-	-	•	-	-	-	•	-
GRP aluminium composite TRP AK upstand	15/30/50	-	-	•	-	-	-	•	-
GRP aluminium composite TRP RAK upstand	30	-	-	•	-	-	-	•	-
GRP AK upstand with base flange	15/30/50	-	-	•	-	-	-	•	-
GRP RAK upstand with base flange	30	-	-	•	-	-	-	•	-
GRP AK upstand with hot flange preparation	30/50	-	-	•	-	-	-	•	-
GRP RAK upstand with hot flange preparation	30/45	-	-	•	-	-	-	•	-
GRP AK upstand round	15/30/50	-	-	-	-	-	-	-	•
Rehabilitation AK upstand									
PVC extension unit	15/30	-	-	-	-	-	-	•	-
Metal riser	25	•	•	-	•	-	-	•	-
External AK upstand									
External AK upstand		-	-	-	-	-	-	•	•

• = available
- = not applicable

Note: All fall-through protection products are also suitable for installation in dome rooflights with SHEV function. Technical clarification is required before installation.